



NT-10C

10 HP, V-4 Cylinder
2 Stage

ITEM 61

043-0098
Intake Low Pressure (4)

L.P. INTAKE VALVE A
L.P. INTAKE VALVE B
L.P. EXHAUST VALVE C
H.P. INTAKE VALVE D
H.P. EXHAUST VALVE E

ITEM 63

043-0100
Exhaust High/Low (4)

ITEM 62

043-099
Intake High Pressure (2)

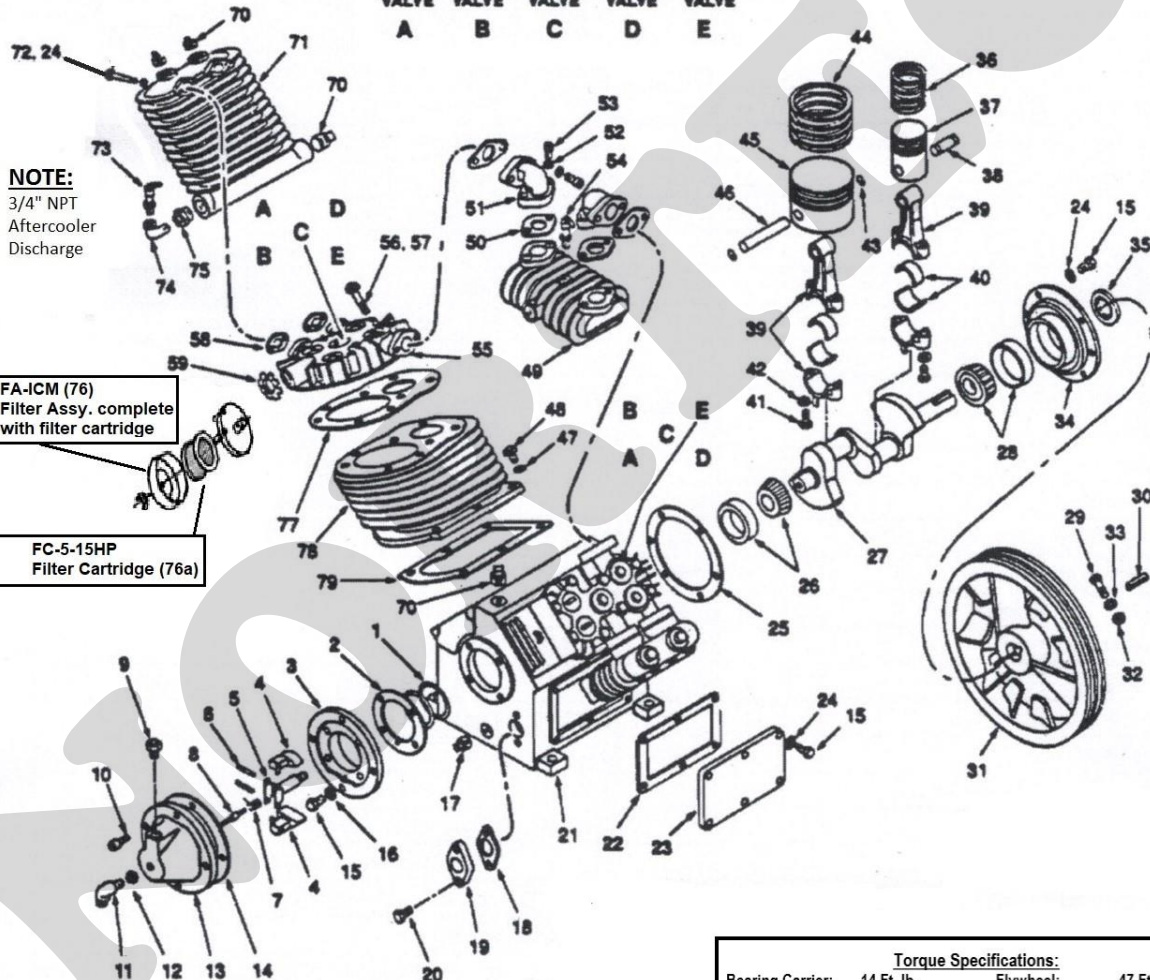

NOTE:
3/4" NPT
Aftercooler
Discharge

FA-ICM (76)
Filter Assy. complete
with filter cartridge

FC-5-15HP
Filter Cartridge (76a)

ITEMS NO. 4 - 5 - 6 - 7 - 8 - 11 - 12
Not supplied with standard unit
Ne sont pas fournis avec modèle standard

Torque Specifications:			
Bearing Carrier:	14 Ft. lb.	Flywheel:	47 Ft. lb.
Unloader cover:	9 Ft. lb.	Sight glass:	14 Ft. lb.
Aftercooler:	14 Ft. lb.	Cylinder:	19 Ft. lb.
Intercooler:	14 Ft. lb.	Connecting Rod:	34 Ft. lb.
Valve Retainers:	51 Ft. lb.	Head:	32 Ft. lb.
Valve Cover:	14 Ft. lb.	Valve:	9 Ft. lb.
Side Cover:	14 Ft. lb.		



10 HP, 4 Cylinder, 2 Stage Pump, Model NT-10C

Key	Part #	Description	Qty	Key	Part #	Description	Qty
1	046-0175	SHIM – Bearing Adj., .005” Thick		44	054-0126	Ring Set – Low Pressure	2
	046-0176	SHIM – Bearing Adj., .010” Thick		45	048-0054	Piston – Low Pressure	2
	046-0177	SHIM – Bearing Adj., .020” Thick		46	052-0027	Wrist Pin, Low Pressure	2
2	046-0227	Gasket – Adapter Plate	1	47	060-0063	Copper Washer - .66” OD x .041” ID	12
3	077-0070	Plate – Centrifugal Unloader	1	48	059-0159	Bolt – Cylinder M10 x 30 mm long	12
4	096-0009	Weight	2	49	082-0013	Aftercooler	1
5	114-0112	Weight Holder	1	50	046-0172	Gasket – Manifold, Aftercooler	4
6	107-0015	Pin	2	51	083-0008	Elbow – Manifold, Aftercooler	2
7	055-0051	Spring	1	52	060-0070	Lock Washer – 8 mm	8
8	078-0011	Plunger	1	53	059-0158	Bolt – Manifold, M8 x 25 mm long	8
9	056-0018	Breather – Crankcase	1	54	SV25-200	Safety Valve – 200 psi	1
10	059-0156	Bolt – M6 x 20 mm long (unloader cover)	4	55	042-0055	Cylinder Head, left	1
11	031-0034	Valve – Air, w/Valve core	1	55R	042-0056	Cylinder Head, right	1
12	058-0084	Nut, Brass, M10	1	56	059-0167	Bolt – Head, M12 x 70 mm long	16
13	077-0071	Housing – Centrifugal Unloader	1	57	060-0105	Washer – M12	16
14	046-0171	Gasket, Unloader Housing	1	58	046-0173	Gasket – Intercooler	4
15	059-0166	Bolt – M8 x 25 mm long	21	59	058-0087	Nut – Conduit 1”	2
16	060-0070	Washer – Lock, 8 mm	4	60	060-0062	Copper Washer – 1.62” x 1.368”	10
17	062-0004	Plug – Oil Drain	1	61	043-0098	Intake – Low Pressure Valve Assy.	4
18	046-0178	Gasket – Oil Sight Glass	1	62	043-0099	Intake – High Pressure Valve Assy.	2
19	032-0031	Oil Sight Glass	1	63	043-0100	Exhaust – High & Low Pressure Assy.	4
20	059-0153	Bolt – M8 x 30 mm long	2	64	043-0094	Spacer – Intake Valve	6
21	049-0028	Crankcase	1	65	043-0095	Spacer – Exhaust Valve	4
22	046-0170	Gasket – Side Cover	1	66	058-0082	Retainer – Valve, Low Pressure Intake	4
23	077-0072	Side Cover	1	67	058-0083	Retainer – Valve Low Pressure	6
24	060-0061	Copper Washer - 0.52” OD x 0.32” ID	26			or High Pressure or Exhaust	
25	046-0168	Gasket – Front Cover	1	68	046-0174	Valve Cover Gasket	6
26	051-0054	Bearing Set – Rear	1	69	077-0073	Valve Cover	6
27	053-0052	Crankshaft	1	70	062-0006	Pipe Plug – 3/4”NPT	7
28	051-0053	Bearing Set – Front	1	71	082-0012	Intercooler	2
29	059-0163	Bolt – M1 Gaskets, 6 x 120 mm long	1	72	059-0157	Bolt – M8 x 90mm long (Intercooler)	8
30	146-0015	Flywheel Key	1	73	SV25-70	Safety Valve – 70 psi	2
31	044-0051	Flywheel – 19”	1	74	064-0022	Elbow – 90° Street, 1/4 ”	2
32	058-0086	Nut – M16 (Flywheel)	1	75	063-0006	Bushing – Reducer	2
33	060-0069	Lock Washer – 16 mm	1	76	FA-ICM	Filter Assembly c/w Filter	2
34	045-0044	Front Bearing Carrier	1	76a	FC-5-15HP	Filter cartridge – NT-5C/NT-10C	2
35	046-0179	Shaft Seal	1	77	046-0166	Gasket – Cylinder Head	2
36	054-0127	Ring Set – High Pressure	2	78	050-0030	Cylinder	2
37	048-0055	Piston – High Pressure	2	79	046-0167	Gasket – Cylinder/Crankcase	2
38	052-0028	Wrist Pin, High Pressure		Kits Available:			
39	047-0054	Connecting Rod	4				
40	051-0055	Bearing Insert	4 pr.				
41	059-0154	Bolt-Rod. M10 x 50 mm long	8		046-0185	Gasket Kit, NT-10C	
42	060-0072	Lock Washer - 10 mm	8		Ring Kit-10C	Ring Kit c/w gaskets	
43	054-0119	Retaining Ring	4		0165-0065	Overhaul Kit, NT-10C Includes: 35 (1), 40 (4 pr.), 44 (2), 36 (1), 046-0185 (1), 76a (2)	